



## LIFT OFF! New Aviation & Automotive Center Opens at Long Beach City College

Faculty, staff, community members and students celebrated the opening of the new Industrial Technology Phase II (Aviation and Automotive Facility) October 9th, with a special ribbon cutting that included a congratulatory airplane fly-over and words of welcome from the LBCC Board of Trustees and College President Eloy Ortiz Oakley. The new 20,000-square-foot facility located at the Pacific Coast Campus (PCC), will serve more than 500 students each semester and will feature the latest technology in automotive mechanics, aero piloting and hybrid mechanics.

"Our new Aviation and Automotive Technology Center will train the region's next generation of aviation mechanics, auto diesel, and hybrid experts," said President Oakley at the ceremony. "These are high-wage jobs that will create tremendous opportunities for the students in the programs."

The building has been certified by the Federal Aviation Administration and was built with \$7.9 million of state prop 47 funds. The new center will allow students to work on cars and planes inside the classroom, and provide faculty members with the latest classroom technology for their courses.

Danny Tan, a student in the automotive program, stated at the opening, "Now we can drive a car right into the classroom."

The new center is one of several new projects financed by the \$176 million facilities bond passed in March 2002. The bond has paid for construction and renovations to buildings on both campuses. These include the new PCC Child Development Center, the new Library Learning Centers on both the PCC and Liberal Arts Campus (LAC), and the construction of the 110,000-square foot South Quad Complex at LAC. 



### From the President.

Dear Friends and Neighbors,

It is my pleasure to send you this report on the impact of Measure E on Long Beach City College. Measure E was passed overwhelmingly by the voters of Long Beach, Lakewood, Signal Hill and Avalon and has enabled our college to increase and improve the programs it provides to our community. I encourage you to review this brochure to find out more about those projects.

Measure E has also allowed Long Beach City College to secure an additional \$60 million dollars in matching funds from the State of California. Without our local bond, these dollars would have been spent in other communities. Measure E ensured that the greater Long Beach area received its fair share of these funds and that our students would benefit.

*Continued on Page 4*



# We're Making Great Progress!

Long Beach City College liberal arts campus

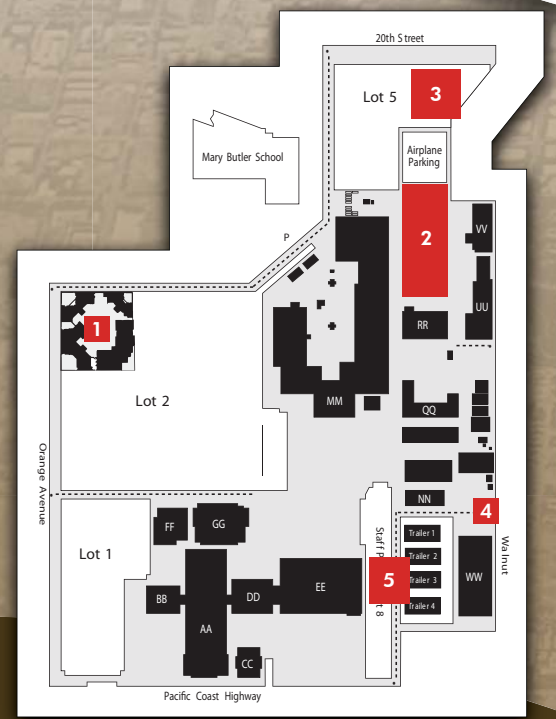
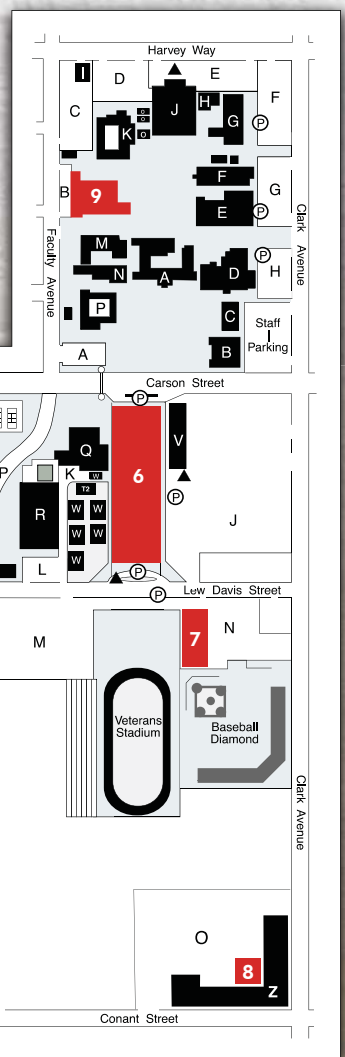

Long Beach City College pacific coast campus

## LBCC student Cheryl Ming is a busy woman.

A mother of two, the Vice President of Delta Alpha Pi (the first community college honors society of disabled students in the western United States), and a representative on LBCC's Student Senate, the Human Services major does not have time to be slowed down by her wheelchair and some of the challenges getting around a campus more than 70 years old.

As Ming transfers to California State University, Long Beach next year she sees Measure E as changing things for the better for the College's disabled students of tomorrow. Her biggest concerns for the renovations and new construction are: the width of door jams, elevators, automatic door openers and, most importantly, the size of the bathroom stalls.

The Measure E Bond Management Team has consulted with the Long Beach Community College District to ensure that the Americans with Disabilities Act Accessibility Guidelines are followed and approved by the Division of the State Architect. "New furniture, fixtures and equipment will be provided with accessible stations to provide equal access," said Bill Adams of the Bond Management Team, adding that increased door and passage width, parking, toilets, signage and seating have all been elements included within the Master Plan for the construction and renovation.

Ming, 37, is very grateful to the College's Disabled Student Programs and Services Department for assisting her on her successful journey through LBCC. "They've been great," she said recently, "I let them know what I need and they accommodate me." ➤



Cheryl Ming

## South Quad Complex (SQC)

This new 110,000 square foot facility at Carson Street and Clark Avenue, built with Measure E bond funds, will house both academic and administration offices, including 30 new "Smart Classrooms" for Creative Arts and Applied Science, History and Political Science and Public Service Departments.

This new building will provide a striking new main entrance to the campus and also relieve stress on parking lots north of Carson Street. Completion is scheduled for summer of 2008. ➤



## From the President.

(Continued from Page 1)

Measure E – along with the additional matching funds – have enabled the college to add new learning resource centers at both campuses, open an aviation and automotive technology center that will train hundreds of students each semester for high paying jobs and to build 30 new classrooms south of Carson Street which will dramatically increase the number of students we can educate every semester among other improvements.

As we celebrate our 80th year of service to this community, I want to sincerely thank you for helping Long Beach City College continue to meet the needs of our students for years to come. I pledge to you that LBCC will strive to keep your trust and to serve this community for another 80 years.

Sincerely,

Eloy Ortiz Oakley  
Superintendent-President,  
Long Beach City College



Long Beach City College  
4901 E. Carson Street  
Long Beach, CA 90808

### Contact Information:

Telephone: (562) 938-5070  
Fax: (562) 938-5065  
Email: MeasureE@lbcc.edu  
Web: <http://bondprogram.lbcc.edu>

## RESIDENTIAL CUSTOMER

Non Profit Org.  
U.S. Postage  
PAID  
Long Beach, CA  
Permit No. 204  
ECRWSS